



NINGBO XINXINGYU TRADE CO., LTD

**RATCHET TIE DOWN
AND
HARDWARE ACCESSORIES
2024 CATALOG**



Ningbo Factory



Thai Factory



Ningbo Xinxingyu Trade Co.,Ltd. is a passionate developer, manufacturer and trader of hardware accessories and ratchet tie down. We've deeply cultivated in this industry for 20 years. For meeting different needs of our customers, we also operates a factory **Thai WP Co.,Ltd.** in Thailand since 2019.

Major products: Ratchet Tie Down and Hardware Accessories

Collaborated with:



 www.nbxxxy.com

 yu@nbxxxy.com

E-Catalog Online





RATCHET TIE DOWN

NINGBO XINXINGYU TRADE CO., LTD CATALOG 2024

QUADWINDER 14' PADDED RATCHET TIE DOWN 1,500 LBS



ITEM NO.	SIZE	SAFE WORKING LOAD	BREAK STRENGTH
HY-LTS-030	2in.W x 20ft.L	5,660 lbs	17,000 lbs

FEATURES	<ul style="list-style-type: none"> -Powerful webbing resists cuts and abrasion -For loads up to 5,660 lbs -Reinforced loop ends -Use to recover stuck vehicle
----------	---

20' TOW STRAP, HOOK END 9,000 LBS



ITEM NO.	SIZE	SAFE WORKING LOAD	BREAK STRENGTH
HY-LTS-031	2in.W x 20ft.L	3,000 lbs	9,000 lbs

FEATURES	<ul style="list-style-type: none"> -PowerWeb Plus webbing resists cuts and abrasion -Zinc-plated, rust-resistant hooks -Use to recover stuck vehicle
----------	---

30' WINCH STRAP, FLAT HOOK 15,000 LBS



ITEM NO.	SIZE	SAFE WORKING LOAD	BREAK STRENGTH
HY-FWS-085	4in.W x 30ft.L	5,000 lbs	15,000 lbs

FEATURES	<ul style="list-style-type: none"> -4" thick and 30' long -Features a rugged, heavy-gauge steel flat hook -High visibility yellow webbing -Designed to withstand the extreme rigors of heavy duty cargo transport
----------	---

30' RATCHET TIE DOWN, J-HOOK 15,000 LBS



ITEM NO.	SIZE	SAFE WORKING LOAD	BREAK STRENGTH
HY-ORS-817	3in.W x 30ft.L	5,000 lbs	15,000 lbs

FEATURES	<ul style="list-style-type: none"> -Oversized plated steel ratchet handle for maximum leverage -High capacity, high visibility webbing that is extra long for securing oversized, tall cargo -Super strong welded and plated steel double "J" hooks
----------	--

TIRE BONNET RATCHET TIE DOWN STRAP 10,000 LBS



ITEM NO.	SIZE	SAFE WORKING LOAD	BREAK STRENGTH
HY-TBS-051	2in.W	3,333 lbs	10,000 lbs

FEATURES	<ul style="list-style-type: none"> -Tire Bonnet with Ratchet safely secures your vehicle without adding unnecessary stress -Made of strong, exible, high visibility yellow webbing -No need for damaging chains -Rust-resistant grommets
----------	--

31" AXEL STRAP 10,000 LBS



ITEM NO.	SIZE	SAFE WORKING LOAD	BREAK STRENGTH
HY-AS-056	2in.W	3,333 lbs	10,000 lbs

FEATURES	<ul style="list-style-type: none"> -Axel Strap is 2" thick and 31" long, and loops around your axel for secure transportation -Has a breaking strength of 10,000 lbs, and a working load limit of 3,333 lbs -Made with a protective sleeve and has a D-ring at each end -Constructed with extra durable webbing
----------	---

QUADWINDER 14' PADDED RATCHET TIE DOWN 1,500 LBS



ITEM NO.	SIZE	SAFE WORKING LOAD	BREAK STRENGTH
HY-PRS-001	1in.W x 14ft.L	500 lbs	1,500 lbs

FEATURES	
	<ul style="list-style-type: none"> -Padded grip and thumb release for more comfort and leverage -Strong and durable -Easy to use -Super strong, Non-Marring Coated Steel S-Hooks -For lighter loads often hauled in a pick-up truck or on a small trailer -Much more secure than rope

10' RATCHET TIE DOWN 3,000 LBS



ITEM NO.	SIZE	SAFE WORKING LOAD	BREAK STRENGTH
HY-HDR-805	1in.W x 10ft.L	1,000 lbs	3,000 lbs

FEATURES	
	<ul style="list-style-type: none"> -Extra sturdy and durable -Easy to use -Super strong, Non-Marring Coated Steel S-Hooks -For heavier loads often hauled in a large pick-up truck or on a medium trailer -Excellent security for traveling longer distance

10' RATCHET TIE DOWN 900 LBS



ITEM NO.	SIZE	SAFE WORKING LOAD	BREAK STRENGTH
HY-LRS-053	1in.W x 10ft.L	300 lbs	900 lbs

FEATURES	<ul style="list-style-type: none"> -Economical, entry level ratchets -Super strong, Non-Marring Coated Steel S-Hooks -For lighter loads often hauled in a pick-up truck or on a small trailer -Much more secure than rope
----------	---

D-HANDLE 10' PADDED RATCHET TIE DOWN 3,000 LBS



ITEM NO.	SIZE	SAFE WORKING LOAD	BREAK STRENGTH
HY-PRS-049	1in.W x 10ft.L	1,000 lbs	3,000 lbs

FEATURES	<ul style="list-style-type: none"> -Padded oversized D-Handle grip and thumb release for more comfort and leverage -Extra sturdy and durable, easy to use -Super strong, Non-Marring Coated Steel S-Hooks -Includes convenient securing strap to make it easy to tie off excess webbing or to keep your straps bundled after use -Extra long webbing on attachment end for hard to reach anchor points -Excellent security for traveling longer distances
----------	---

1" Ratchet



HY-RTS-129



HY-RTS-130



HY-RTS-133



HY-RTS-131



HY-RTS-134



HY-RTS-132

1 1/16" Ratchet



HY-RTS-123



HY-RTS-124



HY-RTS-122

1" Cam Buckle



HY-RSS-124



HY-CBS-151



HY-CBS-152

1.5" Ratchet



HY-RTS-155



HY-RTS-156



HY-RTE-036

2" Ratchet



HY-RTS-213



HY-RTS-214



HY-RTS-215

HARWARE ACCESSORIES

NINGBO XINXINGYU TRADE CO.,LTD CATALOG 2024



E-Track Rail



ITEM	ITEM NO.
	/
E-Track Rail	HY-ET-769 5in.L x 24in.W
	HY-ET-770 5in.L x 60in.W



TRACK SLOTS PROTECTOR



ITEM	E-Track Slot Protector
ITEM NO.	HY-TSP-628E
PACKAGING	Card in PDQ
MOQ	1000PCS
DETAILS	SIZE: 0.6 x 2.88 x 1.44 in COVERS AND PROTECTS E-TRACK SLOTS FOR A CLEAN LOOK AND FINISH EASILY SNAPS INTO SLOTS



ITEM	End Piece For E-Track Systems
ITEM NO.	HY-TSP-745E/X
PACKAGING	Card in PDQ
MOQ	1000PCS
DETAILS	SIZE: 7x2.82x2.82in PROVIDES PROTECTION TO THE TRACK SYSTEM ENDS DESIGNED FOR USE WITH E-TRACK AND X-TRACK RAILS

HOW TO USE



E-TRACK INSTRUCTION

CONNECTING E-TRACK ACCESSORY

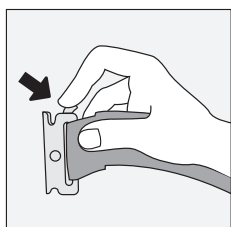

STEP 1:
Press back
locking lever.

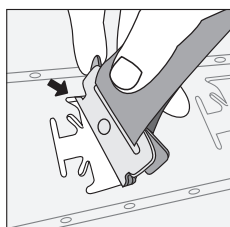

STEP 2:
With locking lever
pressed back,
insert lever end
into E-Track slot.

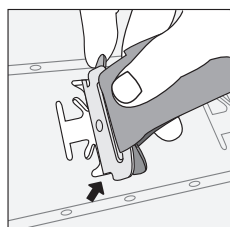

STEP 3:
Insert other end
into E-Track slot.

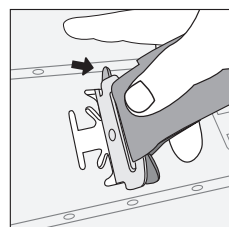

STEP 4:
Release
locking lever.

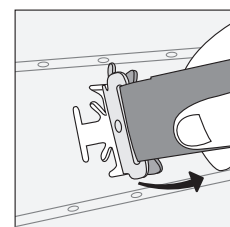

STEP 5:
Pull on
attachment to
ensure that it has
locked securely.

DISCONNECTING E-TRACK ACCESSORY

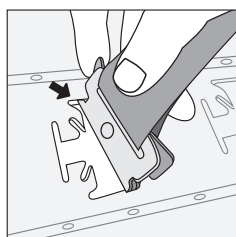

STEP 1:
Press locking
lever and push
toward locking
lever end of slot.

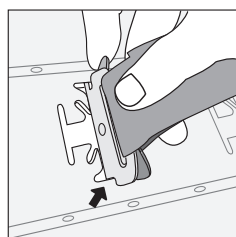

STEP 2:
Lift accessory out
of slot at angle
to remove.

HOOK SERIES



ITEM	PREMIUM EXTRA LARGE J HOOK
ITEM NO.	HY-LJH-629
PACKAGING	Card in PDQ
MOQ	1000PCS
DETAILS	SAFE WORK LOAD: 100LB STEEL PC GRAY W/ RUBBER USE STANDARD E-TRACK CONNECTOR



ITEM	LARGE FLAT HOOK
ITEM NO.	HY-LFH-545
PACKAGING	Card in PDQ
MOQ	1000PCS
DETAILS	SAFE WORK LOAD: 200LB STEEL PC GRAY W/ RUBBER USE STANDARD E-TRACK CONNECTOR



ITEM	PREMIUM EXTENDED DUAL ARM TOOL HOOK
ITEM NO.	HY-ATH-543
PACKAGING	Card in PDQ
MOQ	1000PCS
DETAILS	SAFE WORK LOAD: 200LB STEEL PC GRAY W/ RUBBER USE STANDARD E-TRACK CONNECTOR



ITEM	SMALL SQUARE HOOK
ITEM NO.	HY-SQH-548
PACKAGING	Card in PDQ
MOQ	1000PCS
DETAILS	SAFE WORK LOAD: 200LB STEEL PC GRAY W/ RUBBER USE STANDARD E-TRACK CONNECTOR

APPLICATION SCENE

COMBINE USING WITH E-TRACK & X-TRACK RAIL



Other Hardware Accessories



ITEM	ROTATING BOARD HOLDER
ITEM NO.	HY-RBH-740
PACKAGING	Card in PDQ
MOQ	1000PCS
DETAILS	WELD TO E-TRACK CONNECTOR HEAVY DUTY HINGE ROTATING POSITIONS STEEL ZINC DICHROMATE



ITEM	BOARD HOLDER
ITEM NO.	HY-BH-892
PACKAGING	Card in PDQ
MOQ	1000PCS
DETAILS	USE TO CREATE AN STRAIGHT SHORING BEAM FITTING CONNECTS TO BOTH X- TRACK AND E-TRACK ZINC FINISHED



ITEM	ROPE RING TIE DOWN STRAP
ITEM NO.	HY-RRS-893
PACKAGING	Card in PDQ
MOQ	1000PCS
DETAILS	CAPACITY: 2,000 LB METAL SLEEVE (LEFT IMAGE) WRAPS AROUND E TRACK CONNECTOR



CONNECTORS



ITEM	Track Connectors
ITEM NO.	HY-TC-634
PACKAGING	Card in PDQ
MOQ	1000PCS
DETAILS	SIZE: 1.19 x 0.5 x 3.19 in DIY SOLUTION FOR CREATING YOUR OWN CONNECTION TO X-TRACK OR E-TRACK RAILS



ITEM	Bolt-on Track Connectors
ITEM NO.	HY-BTC-635
PACKAGING	Card in PDQ
MOQ	1000PCS
DETAILS	SIZE: 1.1 x 2.37 x 3.18 in PROVIDES THE APPROPRIATE SECURING ANGLE FOR TIE DOWNS WHEN HAULING VEHICLES



ITEM	Roller Idler Fitting Assembly — For X-Track / E-Track
ITEM NO.	HY-RFA-636
PACKAGING	Card in PDQ
MOQ	1000PCS
DETAILS	SIZE: 4.3 x 1.17 x 3.38 PROVIDES THE APPROPRIATE SECURING ANGLE FOR TIE DOWNS WHEN HAULING VEHICLES

D-Ring Series



ITEM	HEAVY DUTY FORGED D RING BRACKET
ITEM NO.	HY-DRF-823
PACKAGING	Poly bag
MOQ	1000PCS
DETAILS	SAFE WORK LOAD: 4080LB BREAKING STRENGTH: 11781LB STEEL



ITEM	HEAVY DUTY FORGED D RING BRACKET
ITEM NO.	HY-DRF-865
PACKAGING	Poly bag
MOQ	1000PCS
DETAILS	SAFE WORK LOAD: 15586LB BREAKING STRENGTH: 46760LB STEEL



ITEM	Bolt On Light Duty D-Ring
ITEM NO.	HY-LDR-825
PACKAGING	Card in PDQ
MOQ	1000PCS
DETAILS	SAFE WORK LOAD: 800LB BREAKING STRENGTH: 2400LB STEEL ZINC FINISHED



ITEM	Bolt On Light Duty D-Ring
ITEM NO.	HY-LDR-826
PACKAGING	Card in PDQ
MOQ	1000PCS
DETAILS	SAFE WORK LOAD: 400LB BREAKING STRENGTH: 1200LB STEEL ZINC FINISHED



D-Ring Series



ITEM	Surface Mount Light-Duty D-Ring
ITEM NO.	HY-LDR-869
PACKAGING	Card in PDQ
MOQ	1000PCS
DETAILS	SAFE WORK LOAD: 1000LB BREAKING STRENGTH: 3000LB STEEL ZINC FINISHED



ITEM	Bolt-On Recessed D-Ring
ITEM NO.	HY-RDR-809
PACKAGING	Card in PDQ
MOQ	1000PCS
DETAILS	SAFE WORK LOAD: 1667LB BREAKING STRENGTH: 5000LB STEEL ZINC FINISHED



ITEM	Bolt On Recessed Mount D-Ring
ITEM NO.	HY-RDR-817
PACKAGING	Card in PDQ
MOQ	1000PCS
DETAILS	SAFE WORK LOAD: 500LB BREAKING STRENGTH: 1500LB STEEL ZINC FINISHED



ITEM	Surface Mount Light-Duty D-Ring
ITEM NO.	HY-LDR-822
PACKAGING	Card in PDQ
MOQ	1000PCS
DETAILS	SAFE WORK LOAD: 400LB BREAKING STRENGTH: 1200LB STEEL ZINC FINISHED

OTHERS



ITEM	Universal Anchor Points
ITEM NO.	HY-UAP-752
PACKAGING	Card in PDQ
MOQ	1000PCS
DETAILS	Fits trucks with or without bedliners Easy no-tool installation



ITEM	Spare Tire Holder
ITEM NO.	HY-STH-743
PACKAGING	Card in PDQ
MOQ	1000PCS
DETAILS	Ideal for safely storing a spare tire in your trailer Holds most car, trailer, and ATV tires Designed for use with E-Track and X-Track



ITEM	Surface Mount Light-Duty Ring Plate
ITEM NO.	HY-LDR-754
PACKAGING	Card in PDQ
MOQ	1000PCS
DETAILS	SAFE WORK LOAD: 400LB BREAKING STRENGTH: 1200LB STEEL ZINC FINISHED



ITEM	Rope Ring
ITEM NO.	HY-RR-767
PACKAGING	Card in PDQ
MOQ	1000PCS
DETAILS	SAFE WORK LOAD: 2000LB BREAKING STRENGTH: 6000LB STEEL ZINC FINISHED



D-RING SERIES



ITEM	ITEM NO.	WORKING LOAD	BREAK STRENGTH
Locking Anti-Rattle D-Ring	HY-LDR-509(L)	3666 lb	11000 lbs
	HY-LDR-554(M)	1667 lb	5000 lb
	HY-LDR-553(S)	800 lb	2400 lb



ITEM	ITEM NO.	WORKING LOAD	BREAK STRENGTH
Removable D-Ring	HY-RDR-510(L)	3666 lb	11000 lbs
	HY-RDR-556(M)	1667 lb	5000 lb
	HY-RDR-555(S)	800 lb	2400 lb

D-RING SERIES



ITEM	ITEM NO.	WORKING LOAD	BREAK STRENGTH
Covered Anchor Point	HY-CAP-503(L)	3666 lb	11000 lbs
	HY-CAP-552(M)	1667 lb	5000 lb
	HY-CAP-551(S)	800 lb	2400 lb

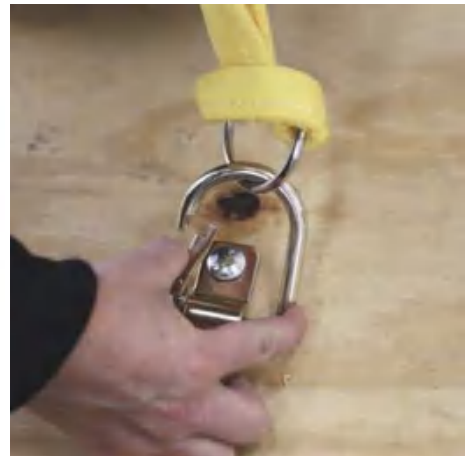

ITEM	ITEM NO.	WORKING LOAD	BREAK STRENGTH
Latching D-Ring	HY-LDR-506(L)	400 lb	1200 lbs
	HY-LDR-550(M)	226 lb	800 lb
	HY-LDR-549(S)	100 lb	300 lb

TRACK BUNGEE



ITEM	ITEM NO.	SIZE	DETAILS
Track Bungee	HY-TB-711	6in	E TRACK CONNECTORS SEWN AT EACH END FINISH: YELLOW ZINC METAL SLEEVE ON BOTH ENDS TO PROTECT THE BUNGEE
	HY-TB-712	9in	
	HY-TB-713	12in	



ITEM	ITEM NO.	SIZE	DETAILS
Track Bungee	HY-TB-714	16-24in	E TRACK CONNECTORS SEWN AT EACH END FINISH: YELLOW ZINC METAL SLEEVE ON BOTH ENDS TO PROTECT THE BUNGEE
	HY-TB-715	22-32in	
	HY-TB-716	28-48in	

ACCESSORIES CATALOG

NINGBO XINXINGYU TRADE CO.,LTD CATALOG 2024

RATCHET TIE DOWN



HYRTD-001

A=103mm
B=325mm
C=140mm
D=75mm
PULL≤10000KG



HYRTD-002

A=78mm
B=325mm
C=140mm
D=75mm
PULL≤10000KG



HYRTD-003

A=53mm
B=330mm
C=105mm
D=60mm
PULL≤5000KG



HYRTD-004

A=53mm
B=300mm
C=105mm
D=60mm
PULL≤5000KG



HYRTD-005

A=52mm
B=230mm
C=105mm
D=58mm
PULL≤5000KG



HYRTD-006

A=52mm
B=230mm
C=105mm
D=58mm
PULL≤5000KG



HYRTD-007

A=52mm
B=230mm
C=105mm
D=58mm
PULL≤5000KG



HYRTD-008

A=52mm
B=230mm
C=110mm
D=58mm
PULL≤5000KG

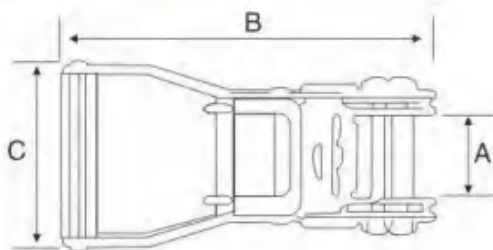

RATCHET TIE DOWN



HYRTD-009
 A=52mm
 B=196mm
 C=105mm
 D=58mm
 PULL≤5000KG



HYRTD-010
 A=52mm
 B=230mm
 C=110mm
 D=58mm
 PULL≤5000KG



HYRTD-011
 A=52mm
 B=165mm
 C=78mm
 D=58mm
 PULL≤5000KG



HYRTD-012
 A=52mm
 B=160mm
 C=78mm
 D=52mm
 PULL≤2000KG



HYRTD-013
 A=54mm
 B=145mm
 C=93mm
 D=40mm
 PULL≤2000KG



HYRTD-014
 A=39mm
 B=155mm
 C=85mm
 D=50mm
 PULL≤3000KG



HYRTD-015
 A=39mm
 B=160mm
 C=85mm
 D=50mm
 PULL≤3000KG



HYRTD-016
 A=39mm
 B=160mm
 C=85mm
 D=50mm
 PULL≤3000KG

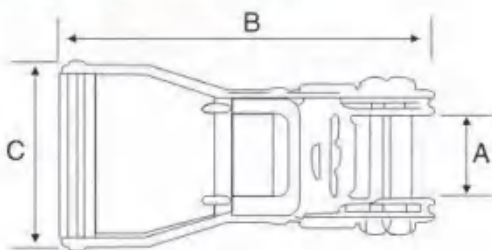

RATCHET TIE DOWN



HYRTD-017

A=39mm
B=130mm
C=75mm
D=40mm
PULL ≤ 2000KG



HYRTD-018

A=39mm
B=155mm
C=60mm
D=50mm
PULL ≤ 3000KG



HYRTD-019

A=34mm
B=150mm
C=70mm
D=45mm
PULL ≤ 1500KG



HYRTD-020

A=34mm
B=145mm
C=80mm
D=45mm
PULL ≤ 1500KG



HYRTD-021

A=34mm
B=170mm
C=65mm
D=45mm
PULL ≤ 1500KG



HYRTD-022

A=28mm
B=125mm
C=70mm
D=42mm
PULL ≤ 1500KG



HYRTD-023

A=28mm
B=130mm
C=65mm
D=42mm
PULL ≤ 1500KG



HYRTD-024

A=28mm
B=120mm
C=62mm
D=42mm
PULL ≤ 1500KG

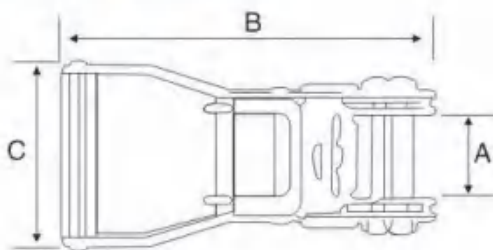

RATCHET TIE DOWN



HYRTD-025
 A=28mm
 B=130mm
 C=46mm
 D=42mm
 PULL≤1500KG



HYRTD-026
 A=28mm
 B=110mm
 C=46mm
 D=42mm
 PULL≤1500KG



HYRTD-027
 A=26mm
 B=135mm
 C=60mm
 D=42mm
 PULL≤1200KG



HYRTD-028
 A=26mm
 B=112mm
 C=37mm
 D=42mm
 PULL≤680KG



HYRTD-029
 A=26mm
 B=112mm
 C=37mm
 D=42mm
 PULL≤680KG



HYRTD-030
 A=26mm
 B=112mm
 C=37mm
 D=42mm
 PULL≤680KG



HYRTD-031
 A=26mm
 B=115mm
 C=37mm
 D=42mm
 PULL≤680KG



HYRTD-032
 A=26mm
 B=120mm
 C=37mm
 D=42mm
 PULL≤680KG

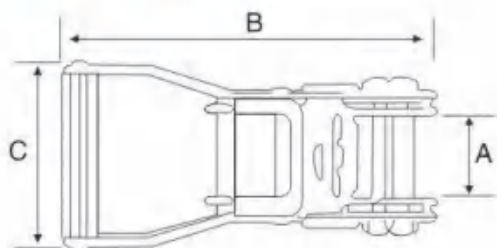

BUCKLES



HY-OBU-041

A=52mm
B=132mm
C=60mm



HYOBU-043SS

A=52mm
B=180mm
C=65mm
D=25mm
PULL≤600KG



HYOBU-044SS

A=52mm
B=170mm
C=65mm
D=25mm
PULL≤800KG



HYOBU-045SS

A=48mm
B=150mm
C=60mm
D=25mm
PULL≤800KG



HYPB-046SS

A=52mm
B=110mm
C=68mm
D=22mm
PULL≤450KG



HYPB-047SS

A=26mm
B=90mm
C=42mm
D=18mm
PULL≤450KG



HYAP-003

The head : Chrome-plated zinc alloy
The Screw: 3 / 8 "
The length: 85mm



HYAP-004

The head : Chrome-plated zinc alloy
The Screw: 3 / 8 "
The length: 85mm

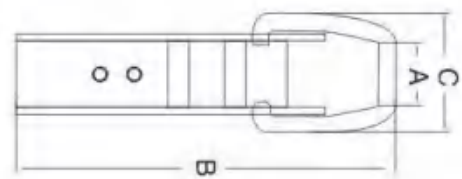
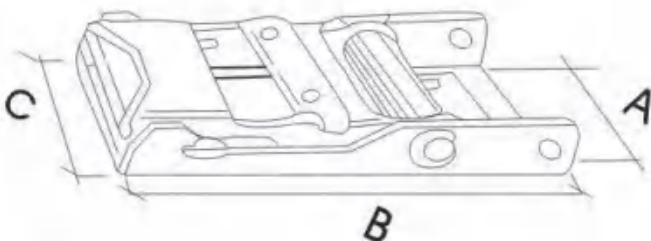

BUCKLES



HYBU-048
 A=54mm
 B=75mm
 C=62mm
 D=30mm
 PULL ≤ 1000KG



HYBU-049
 A=42mm
 B=62mm
 C=48mm
 D=28mm
 PULL ≤ 800KG



HYBU-050
 A=36mm
 B=60mm
 C=48mm
 D=26mm
 PULL ≤ 800KG



HYBU-051
 A=28mm
 B=64mm
 C=36mm
 D=26mm
 PULL ≤ 680KG



HYBU-052
 A=28mm
 B=64mm
 C=44mm
 D=26mm
 PULL ≤ 680KG



HYPF-053
 A=38mm
 B=145mm
 C=100mm
 D=60mm
 PULL ≤ 1600KG



HYPF-054
 A=30mm
 B=104mm
 C=70mm
 D=45mm
 PULL ≤ 800KG



HYSH-055A
 A=24mm
 B=80mm
 C=8mm
 PULL ≤ 680KG

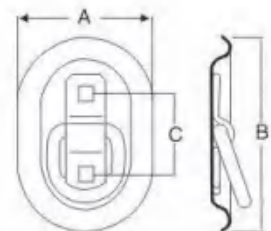
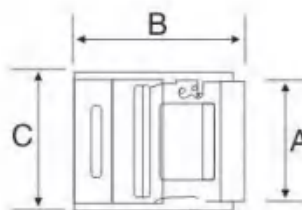
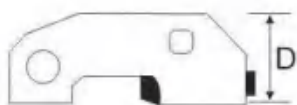

HOOK



HYSH-055B
 A=24mm
 B=96mm
 C=10.5mm
 PULL ≤ 1500KG



HYSH-056
 A=24mm
 B=102mm
 C=9.8mm
 PULL ≤ 2500KG



HYSH-057
 A=24mm
 B=125mm
 C=10mm
 PULL ≤ 1500KG



HYSH-058
 A=24mm
 B=108mm
 C=8mm
 PULL ≤ 800KG



HYSH-059
 A=24mm
 B=125mm
 C=8mm
 PULL ≤ 800KG



HYSH-060
 A=27mm
 B=110mm
 C=10mm
 PULL ≤ 1500KG



HYSH-061
 A=26mm
 B=102mm
 C=9.8mm
 PULL ≤ 2500KG



HYDH-062
 A=28mm
 B=65mm
 C=8mm
 PULL ≤ 1500KG

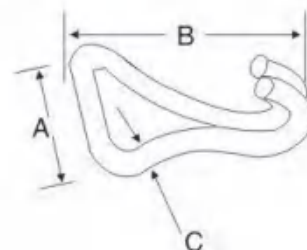
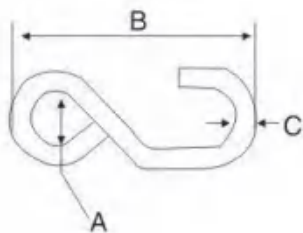

HOOK



HYDH-063
 A=26mm
 B=52mm
 C=7.2mm
 PULL ≤ 1200KG



HYDH-064
 A=52mm
 B=120mm
 C=12.2mm
 PULL ≤ 5000KG



HYDH-065
 A=52mm
 B=85mm
 C=11.5mm
 PULL ≤ 5000KG



HYDH-066
 A=52mm
 B=98mm
 C=9.8mm
 PULL ≤ 5000KG



HYDH-067
 A=52mm
 B=80mm
 C=9.8mm
 PULL ≤ 3000KG



HYDH-068
 A=39mm
 B=65mm
 C=8mm
 PULL ≤ 2000KG



HYDH-069
 A=26mm
 B=50mm
 C=7.2mm
 PULL ≤ 1200KG



HY-FH-081
 A=15mm
 B=67mm
 C=4mm

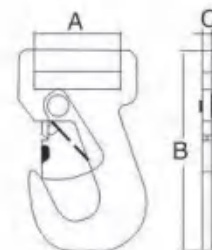
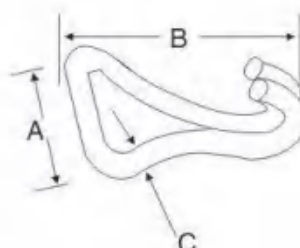
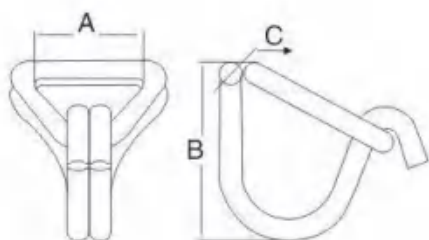

HOOK



HYFH-071
 A=26mm
 B=96mm
 C=4mm
 PULL ≤ 1500KG



HYFH-072
 A=45.5mm
 B=108mm
 C=4.5mm
 PULL ≤ 2500KG



HYFH-073
 A=50mm
 B=160mm
 C=6mm
 PULL ≤ 4540KG



HYFH-074
 A=50mm
 B=160mm
 C=6mm
 PULL ≤ 4540KG



HYFH-075
 A=50mm
 B=96mm
 C=4.5mm
 PULL ≤ 2000KG



HYFH-076
 A=50mm
 B=75mm
 C=4.5mm
 PULL ≤ 3000KG



HYFH-077
 A=70mm
 B=98mm
 C=5mm
 PULL ≤ 6800KG

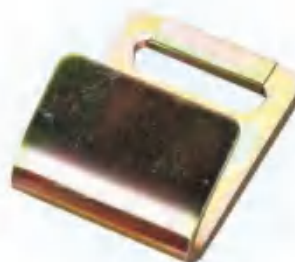

HYFH-078
 A=48mm
 B=92mm
 C=4.5mm
 PULL ≤ 5000KG

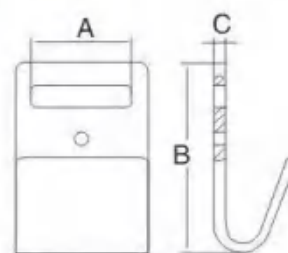
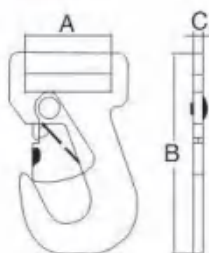

HOOK



HY-FH-080

L=75.6mm
W=90mm
H=5.5mm



HY-FH-082

L=75mm
W=97mm
H=91mm



HY-FH-081

L=65mm
W=62mm
H=31mm



HY-SJH-001

L=83.6mm
W=115.5mm
H=32mm



HY-FH-082

L=83mm
W=98mm
H=40mm



HY-SJH-002

L=87mm
W=100mm
H=30mm



HY-WIN-001

L=123mm
W=102mm
H=95mm



HY-SJH-003

L=66mm
W=97mm
H=29mm

D RING



HYFH-079
 A=29mm
 B=53mm
 C=3mm
 PULL≤1500KG



HYFH-080
 A=26mm
 B=30mm
 C=2.5mm
 PULL≤800KG



HYDR-081
 A=52mm
 B=79mm
 C=5mm
 PULL≤5000KG



HYDR-082
 A=52mm
 B=73mm
 C=11.5mm
 PULL≤5000KG



HYDR-083
 A=50mm
 B=68mm
 C=5mm
 PULL≤5000KG



HYDR-084
 A=50mm
 B=60mm
 C=7mm
 PULL≤2000KG



HYDR-085
 A=38mm
 B=60mm
 C=10mm
 PULL≤3000KG



HYPB-086
 A=32mm
 B=180mm
 C=58mm
 PULL≤2000KG

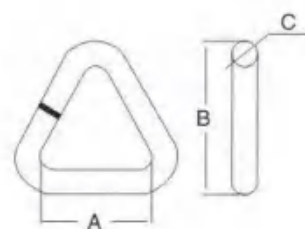
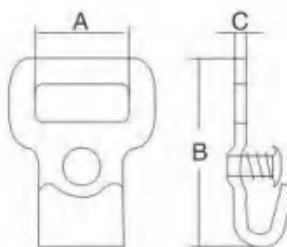
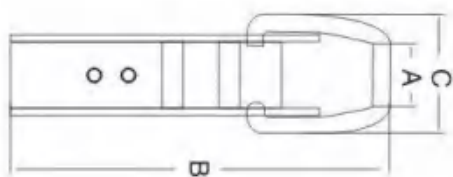

HOOK/DOUBLE STUD FITTING



HY-DSF-095

B=62mm



HYUH-088

A=52mm
B=92mm
C=17mm
PULL ≤ 10000KG



HYUH-089

A=52mm
B=60mm
C=11.5mm
PULL ≤ 5000KG



HYUH-090

A=39mm
B=55mm
C=10mm
PULL ≤ 3000KG



HYSH-091

A=52mm
B=38mm
C=10mm
PULL ≤ 3000KG



HYSH-092

A=52mm
B=36mm
C=8mm
PULL ≤ 1500KG



HYDSF-093

A=44mm
B=100mm
C=7mm
PULL ≤ 2300KG



HYDSF-094

A=38mm
B=105mm
C=8mm
PULL ≤ 2300KG

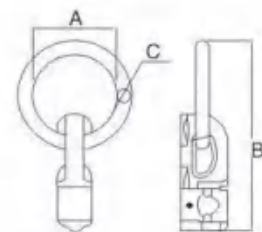
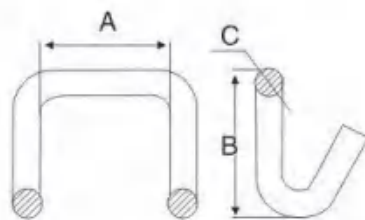
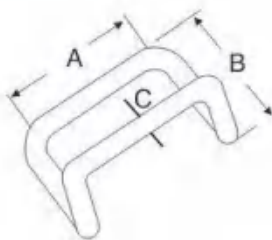

FASTENER



HYSSF-095
 A=45mm
 B=78mm
 C=5mm
 PULL≤1800KG



HYSSF-096
 A=35mm
 B=66mm
 C=5mm
 PULL≤1800KG



HYSSF-097
 A=29mm
 B=62mm
 C=5mm
 PULL≤1800KG



HYSSF-098
 A=10mm
 B=49.5mm
 C=1.5mm
 PULL≤710KG



HYSSF-099
 A=38mm
 B=90mm
 C=8mm
 PULL≤3000KG



HYFH-100
 A=52mm
 B=77mm
 C=30mm
 PULL≤1600KG



HYFN-001
 A=12mm
 B=101.5mm
 C=20mm



HYFN-002
 A=M12mm
 B=76mm
 C=20mm

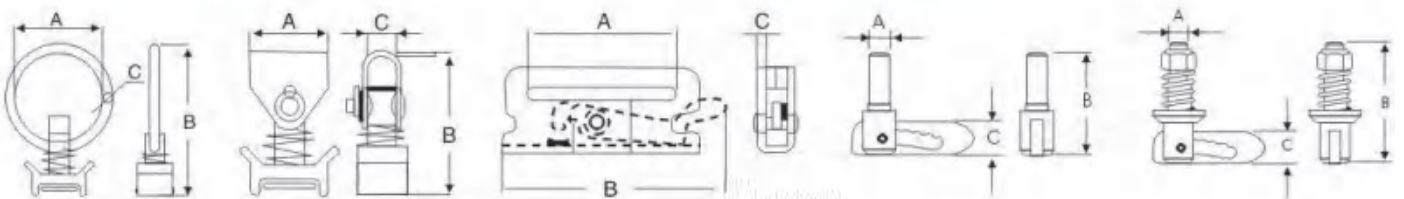

NINGBO XINXINGYU TRADE CO., LTD

Ningbo Factory

 No.748-6 Wuxiang East Road,
Wuxiang Town, Yinzhou,
Ningbo, China

Thai Factory

 371/4 Moo 6, Tambol Bowin,
Amphur Sriracha, Chonburi
20230 Head Office

 www.nbxy.com

 yu@nbxy.com