



**NINGBO HENGYU  
AUTO PARTS MANUFACTURER**

**RATCHET TIE DOWN  
AND  
HARDWARE ACCESSORIES  
2023 CATALOG**





## Ningbo Office



## Thai Office



**Ningbo Hengyu Auto Parts Manufacturer** is a passionate developer, manufacturer and supplier of hardware accessories and ratchet tie down. We've deeply cultivated in this industry for nearly 20 years. For meeting different needs of our customers, we also operates a factory **Thai WP Co.,Ltd.** in Thailand since 2019.

**Major products:** Ratchet Tie Down and Hardware Accessories

**Collaborated with:**



 [www.cnhengyu.com](http://www.cnhengyu.com)

 [sales@cnhengyu.com](mailto:sales@cnhengyu.com)

E-Catalog Online





# RATCHET TIE DOWN

NINGBO YINZHOU HENGYU AUTO PARTS MANUFACTURER CATALOG 2023

## QUADWINDER 14' PADDED RATCHET TIE DOWN 1,500 LBS



ITEM NO.	SIZE	SAFE WORKING LOAD	BREAK STRENGTH
HY-LTS-030	2in.W x 20ft.L	5,660 lbs	17,000 lbs

FEATURES	<ul style="list-style-type: none"> <li>-Powerful webbing resists cuts and abrasion</li> <li>-For loads up to 5,660 lbs</li> <li>-Reinforced loop ends</li> <li>-Use to recover stuck vehicle</li> </ul>
----------	---

## 20' TOW STRAP, HOOK END 9,000 LBS



ITEM NO.	SIZE	SAFE WORKING LOAD	BREAK STRENGTH
HY-LTS-031	2in.W x 20ft.L	3,000 lbs	9,000 lbs

FEATURES	<ul style="list-style-type: none"> <li>-PowerWeb Plus webbing resists cuts and abrasion</li> <li>-Zinc-plated, rust-resistant hooks</li> <li>-Use to recover stuck vehicle</li> </ul>
----------	---

## 30' WINCH STRAP, FLAT HOOK 15,000 LBS



ITEM NO.	SIZE	SAFE WORKING LOAD	BREAK STRENGTH
HY-FWS-085	4in.W x 30ft.L	5,000 lbs	15,000 lbs

FEATURES	<ul style="list-style-type: none"> <li>-4" thick and 30' long</li> <li>-Features a rugged, heavy-gauge steel flat hook</li> <li>-High visibility yellow webbing</li> <li>-Designed to withstand the extreme rigors of heavy duty cargo transport</li> </ul>
----------	---

## 30' RATCHET TIE DOWN, J-HOOK 15,000 LBS



ITEM NO.	SIZE	SAFE WORKING LOAD	BREAK STRENGTH
HY-ORS-817	3in.W x 30ft.L	5,000 lbs	15,000 lbs

FEATURES	<ul style="list-style-type: none"> <li>-Oversized plated steel ratchet handle for maximum leverage</li> <li>-High capacity, high visibility webbing that is extra long for securing oversized, tall cargo</li> <li>-Super strong welded and plated steel double "J" hooks</li> </ul>
----------	--



## TIRE BONNET RATCHET TIE DOWN STRAP 10,000 LBS



ITEM NO.	SIZE	SAFE WORKING LOAD	BREAK STRENGTH
HY-TBS-051	2in.W	3,333 lbs	10,000 lbs

FEATURES	<ul style="list-style-type: none"> <li>-Tire Bonnet with Ratchet safely secures your vehicle without adding unnecessary stress</li> <li>-Made of strong, flexible, high visibility yellow webbing</li> <li>-No need for damaging chains</li> <li>-Rust-resistant grommets</li> </ul>
----------	--

## 31" AXEL STRAP 10,000 LBS

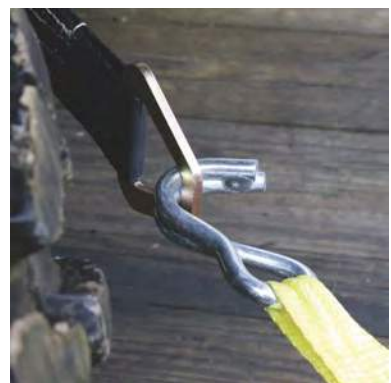

ITEM NO.	SIZE	SAFE WORKING LOAD	BREAK STRENGTH
HY-AS-056	2in.W	3,333 lbs	10,000 lbs

FEATURES	<ul style="list-style-type: none"> <li>-Axel Strap is 2" thick and 31" long, and loops around your axel for secure transportation</li> <li>-Has a breaking strength of 10,000 lbs, and a working load limit of 3,333 lbs</li> <li>-Made with a protective sleeve and has a D-ring at each end</li> <li>-Constructed with extra durable webbing</li> </ul>
----------	---

## QUADWINDER 14' PADDED RATCHET TIE DOWN 1,500 LBS



ITEM NO.	SIZE	SAFE WORKING LOAD	BREAK STRENGTH
HY-PRS-001	1in.W x 14ft.L	500 lbs	1,500 lbs

FEATURES	
	<ul style="list-style-type: none"> <li>-Padded grip and thumb release for more comfort and leverage</li> <li>-Strong and durable</li> <li>-Easy to use</li> <li>-Super strong, Non-Marring Coated Steel S-Hooks</li> <li>-For lighter loads often hauled in a pick-up truck or on a small trailer</li> <li>-Much more secure than rope</li> </ul>

## 10' RATCHET TIE DOWN 3,000 LBS



ITEM NO.	SIZE	SAFE WORKING LOAD	BREAK STRENGTH
HY-HDR-805	1in.W x 10ft.L	1,000 lbs	3,000 lbs

FEATURES	
	<ul style="list-style-type: none"> <li>-Extra sturdy and durable</li> <li>-Easy to use</li> <li>-Super strong, Non-Marring Coated Steel S-Hooks</li> <li>-For heavier loads often hauled in a large pick-up truck or on a medium trailer</li> <li>-Excellent security for traveling longer distance</li> </ul>

## 10' RATCHET TIE DOWN 900 LBS



ITEM NO.	SIZE	SAFE WORKING LOAD	BREAK STRENGTH
HY-LRS-053	1in.W x 10ft.L	300 lbs	900 lbs

FEATURES	<ul style="list-style-type: none"> <li>-Economical, entry level ratchets</li> <li>-Super strong, Non-Marring Coated Steel S-Hooks</li> <li>-For lighter loads often hauled in a pick-up truck or on a small trailer</li> <li>-Much more secure than rope</li> </ul>
----------	---

## D-HANDLE 10' PADDED RATCHET TIE DOWN 3,000 LBS



ITEM NO.	SIZE	SAFE WORKING LOAD	BREAK STRENGTH
HY-PRS-049	1in.W x 10ft.L	1,000 lbs	3,000 lbs

FEATURES	<ul style="list-style-type: none"> <li>-Padded oversized D-Handle grip and thumb release for more comfort and leverage</li> <li>-Extra sturdy and durable, easy to use</li> <li>-Super strong, Non-Marring Coated Steel S-Hooks</li> <li>-Includes convenient securing strap to make it easy to tie off excess webbing or to keep your straps bundled after use</li> <li>-Extra long webbing on attachment end for hard to reach anchor points</li> <li>-Excellent security for traveling longer distances</li> </ul>
----------	---



# 1" Ratchet



HY-RTS-129



HY-RTS-130



HY-RTS-133



HY-RTS-131



HY-RTS-134



HY-RTS-132

## 1 1/16" Ratchet



HY-RTS-123



HY-RTS-124



HY-RTS-122

## 1" Cam Buckle



HY-RSS-124



HY-CBS-151



HY-CBS-152

## 1.5" Ratchet



HY-RTS-155



HY-RTS-156



HY-RTE-036

## 2" Ratchet



HY-RTS-213



HY-RTS-214



HY-RTS-215



# HARWARE ACCESSORIES

NINGBO YINZHOU HENGYU AUTO PARTS MANUFACTURER CATALOG 2023





# E-Track Rail



ITEM	ITEM NO.
	/
E-Track Rail	HY-ET-769 5in.L x 24in.W
	HY-ET-770 5in.L x 60in.W



# TRACK SLOTS PROTECTOR

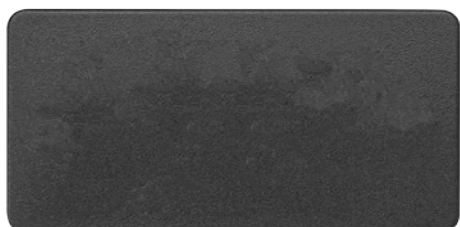

<b>ITEM</b>	E-Track Slot Protector
<b>ITEM NO.</b>	HY-TSP-628E
<b>PACKAGING</b>	Card in PDQ
<b>MOQ</b>	1000PCS
<b>DETAILS</b>	SIZE: 0.6 x 2.88 x 1.44 in COVERS AND PROTECTS E-TRACK SLOTS FOR A CLEAN LOOK AND FINISH EASILY SNAPS INTO SLOTS



<b>ITEM</b>	End Piece For E-Track Systems
<b>ITEM NO.</b>	HY-TSP-745E/X
<b>PACKAGING</b>	Card in PDQ
<b>MOQ</b>	1000PCS
<b>DETAILS</b>	SIZE: 7x2.82x2.82in PROVIDES PROTECTION TO THE TRACK SYSTEM ENDS DESIGNED FOR USE WITH E-TRACK AND X-TRACK RAILS

## HOW TO USE





# E-TRACK INSTRUCTION

## CONNECTING E-TRACK ACCESSORY

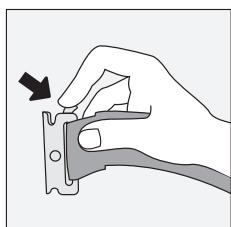

**STEP 1:**  
Press back  
locking lever.

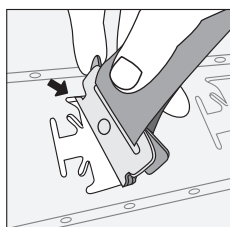

**STEP 2:**  
With locking lever  
pressed back,  
insert lever end  
into E-Track slot.

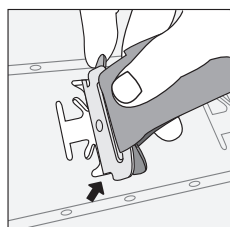

**STEP 3:**  
Insert other end  
into E-Track slot.

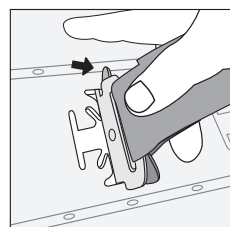

**STEP 4:**  
Release  
locking lever.

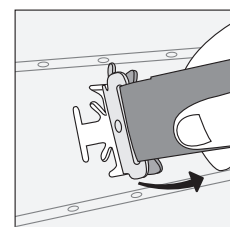

**STEP 5:**  
Pull on  
attachment to  
ensure that it has  
locked securely.

## DISCONNECTING E-TRACK ACCESSORY

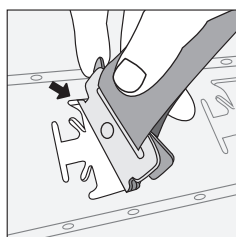

**STEP 1:**  
Press locking  
lever and push  
toward locking  
lever end of slot.

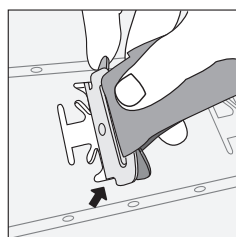

**STEP 2:**  
Lift accessory out  
of slot at angle  
to remove.

# HOOK SERIES



<b>ITEM</b>	PREMIUM EXTRA LARGE J HOOK
<b>ITEM NO.</b>	HY-LJH-629
<b>PACKAGING</b>	Card in PDQ
<b>MOQ</b>	1000PCS
<b>DETAILS</b>	SAFE WORK LOAD: 100LB STEEL PC GRAY W/ RUBBER USE STANDARD E-TRACK CONNECTOR



<b>ITEM</b>	LARGE FLAT HOOK
<b>ITEM NO.</b>	HY-LFH-545
<b>PACKAGING</b>	Card in PDQ
<b>MOQ</b>	1000PCS
<b>DETAILS</b>	SAFE WORK LOAD: 200LB STEEL PC GRAY W/ RUBBER USE STANDARD E-TRACK CONNECTOR



<b>ITEM</b>	PREMIUM EXTENDED DUAL ARM TOOL HOOK
<b>ITEM NO.</b>	HY-ATH-543
<b>PACKAGING</b>	Card in PDQ
<b>MOQ</b>	1000PCS
<b>DETAILS</b>	SAFE WORK LOAD: 200LB STEEL PC GRAY W/ RUBBER USE STANDARD E-TRACK CONNECTOR



<b>ITEM</b>	SMALL SQUARE HOOK
<b>ITEM NO.</b>	HY-SQH-548
<b>PACKAGING</b>	Card in PDQ
<b>MOQ</b>	1000PCS
<b>DETAILS</b>	SAFE WORK LOAD: 200LB STEEL PC GRAY W/ RUBBER USE STANDARD E-TRACK CONNECTOR

# APPLICATION SCENE

COMBINE USING WITH E-TRACK & X-TRACK RAIL





# Other Hardware Accessories



<b>ITEM</b>	ROTATING BOARD HOLDER
<b>ITEM NO.</b>	HY-RBH-740
<b>PACKAGING</b>	Card in PDQ
<b>MOQ</b>	1000PCS
<b>DETAILS</b>	WELD TO E-TRACK CONNECTOR HEAVY DUTY HINGE ROTATING POSITIONS STEEL ZINC DICHROMATE

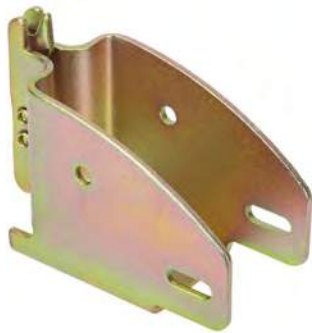

<b>ITEM</b>	BOARD HOLDER
<b>ITEM NO.</b>	HY-BH-892
<b>PACKAGING</b>	Card in PDQ
<b>MOQ</b>	1000PCS
<b>DETAILS</b>	USE TO CREATE AN STRAIGHT SHORING BEAM FITTING CONNECTS TO BOTH X- TRACK AND E-TRACK ZINC FINISHED



<b>ITEM</b>	ROPE RING TIE DOWN STRAP
<b>ITEM NO.</b>	HY-RRS-893
<b>PACKAGING</b>	Card in PDQ
<b>MOQ</b>	1000PCS
<b>DETAILS</b>	CAPACITY: 2,000 LB METAL SLEEVE (LEFT IMAGE) WRAPS AROUND E TRACK CONNECTOR



# CONNECTORS



<b>ITEM</b>	Track Connectors
<b>ITEM NO.</b>	HY-TC-634
<b>PACKAGING</b>	Card in PDQ
<b>MOQ</b>	1000PCS
<b>DETAILS</b>	SIZE: 1.19 x 0.5 x 3.19 in DIY SOLUTION FOR CREATING YOUR OWN CONNECTION TO X-TRACK OR E-TRACK RAILS



<b>ITEM</b>	Bolt-on Track Connectors
<b>ITEM NO.</b>	HY-BTC-635
<b>PACKAGING</b>	Card in PDQ
<b>MOQ</b>	1000PCS
<b>DETAILS</b>	SIZE: 1.1 x 2.37 x 3.18 in PROVIDES THE APPROPRIATE SECURING ANGLE FOR TIE DOWNS WHEN HAULING VEHICLES



<b>ITEM</b>	Roller Idler Fitting Assembly — For X-Track / E-Track
<b>ITEM NO.</b>	HY-RFA-636
<b>PACKAGING</b>	Card in PDQ
<b>MOQ</b>	1000PCS
<b>DETAILS</b>	SIZE: 4.3 x 1.17 x 3.38 PROVIDES THE APPROPRIATE SECURING ANGLE FOR TIE DOWNS WHEN HAULING VEHICLES



# D-Ring Series



<b>ITEM</b>	HEAVY DUTY FORGED D RING BRACKET
<b>ITEM NO.</b>	HY-DRF-823
<b>PACKAGING</b>	Poly bag
<b>MOQ</b>	1000PCS
<b>DETAILS</b>	SAFE WORK LOAD: 4080LB BREAKING STRENGTH: 11781LB STEEL



<b>ITEM</b>	HEAVY DUTY FORGED D RING BRACKET
<b>ITEM NO.</b>	HY-DRF-865
<b>PACKAGING</b>	Poly bag
<b>MOQ</b>	1000PCS
<b>DETAILS</b>	SAFE WORK LOAD: 15586LB BREAKING STRENGTH: 46760LB STEEL



<b>ITEM</b>	Bolt On Light Duty D-Ring
<b>ITEM NO.</b>	HY-LDR-825
<b>PACKAGING</b>	Card in PDQ
<b>MOQ</b>	1000PCS
<b>DETAILS</b>	SAFE WORK LOAD: 800LB BREAKING STRENGTH: 2400LB STEEL ZINC FINISHED



<b>ITEM</b>	Bolt On Light Duty D-Ring
<b>ITEM NO.</b>	HY-LDR-826
<b>PACKAGING</b>	Card in PDQ
<b>MOQ</b>	1000PCS
<b>DETAILS</b>	SAFE WORK LOAD: 400LB BREAKING STRENGTH: 1200LB STEEL ZINC FINISHED



# D-Ring Series



<b>ITEM</b>	Surface Mount Light-Duty D-Ring
<b>ITEM NO.</b>	HY-LDR-869
<b>PACKAGING</b>	Card in PDQ
<b>MOQ</b>	1000PCS
<b>DETAILS</b>	SAFE WORK LOAD: 1000LB BREAKING STRENGTH: 3000LB STEEL ZINC FINISHED



<b>ITEM</b>	Bolt-On Recessed D-Ring
<b>ITEM NO.</b>	HY-RDR-809
<b>PACKAGING</b>	Card in PDQ
<b>MOQ</b>	1000PCS
<b>DETAILS</b>	SAFE WORK LOAD: 1667LB BREAKING STRENGTH: 5000LB STEEL ZINC FINISHED



<b>ITEM</b>	Bolt On Recessed Mount D-Ring
<b>ITEM NO.</b>	HY-RDR-817
<b>PACKAGING</b>	Card in PDQ
<b>MOQ</b>	1000PCS
<b>DETAILS</b>	SAFE WORK LOAD: 500LB BREAKING STRENGTH: 1500LB STEEL ZINC FINISHED

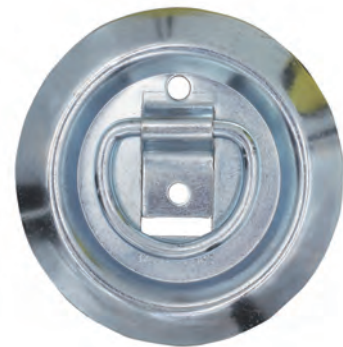

<b>ITEM</b>	Surface Mount Light-Duty D-Ring
<b>ITEM NO.</b>	HY-LDR-822
<b>PACKAGING</b>	Card in PDQ
<b>MOQ</b>	1000PCS
<b>DETAILS</b>	SAFE WORK LOAD: 400LB BREAKING STRENGTH: 1200LB STEEL ZINC FINISHED



# OTHERS



<b>ITEM</b>	Universal Anchor Points
<b>ITEM NO.</b>	HY-UAP-752
<b>PACKAGING</b>	Card in PDQ
<b>MOQ</b>	1000PCS
<b>DETAILS</b>	Fits trucks with or without bedliners Easy no-tool installation



<b>ITEM</b>	Spare Tire Holder
<b>ITEM NO.</b>	HY-STH-743
<b>PACKAGING</b>	Card in PDQ
<b>MOQ</b>	1000PCS
<b>DETAILS</b>	Ideal for safely storing a spare tire in your trailer Holds most car, trailer, and ATV tires Designed for use with E-Track and X-Track



<b>ITEM</b>	Surface Mount Light-Duty Ring Plate
<b>ITEM NO.</b>	HY-LDR-754
<b>PACKAGING</b>	Card in PDQ
<b>MOQ</b>	1000PCS
<b>DETAILS</b>	SAFE WORK LOAD: 400LB BREAKING STRENGTH: 1200LB STEEL ZINC FINISHED



<b>ITEM</b>	Rope Ring
<b>ITEM NO.</b>	HY-RR-767
<b>PACKAGING</b>	Card in PDQ
<b>MOQ</b>	1000PCS
<b>DETAILS</b>	SAFE WORK LOAD: 2000LB BREAKING STRENGTH: 6000LB STEEL ZINC FINISHED



# D-RING SERIES



ITEM	ITEM NO.	WORKING LOAD	BREAK STRENGTH
Locking Anti-Rattle D-Ring	HY-LDR-509(L)	3666 lb	11000 lbs
	HY-LDR-554(M)	1667 lb	5000 lb
	HY-LDR-553(S)	800 lb	2400 lb



ITEM	ITEM NO.	WORKING LOAD	BREAK STRENGTH
Removable D-Ring	HY-RDR-510(L)	3666 lb	11000 lbs
	HY-RDR-556(M)	1667 lb	5000 lb
	HY-RDR-555(S)	800 lb	2400 lb



# D-RING SERIES

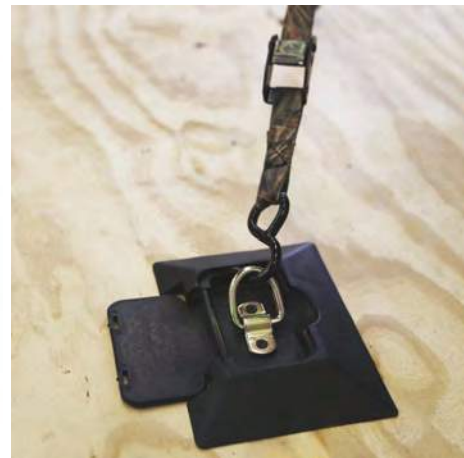
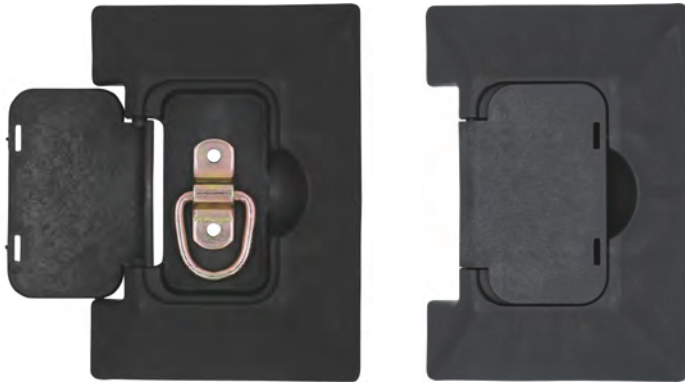

ITEM	ITEM NO.	WORKING LOAD	BREAK STRENGTH
Covered Anchor Point	HY-CAP-503(L)	3666 lb	11000 lbs
	HY-CAP-552(M)	1667 lb	5000 lb
	HY-CAP-551(S)	800 lb	2400 lb



ITEM	ITEM NO.	WORKING LOAD	BREAK STRENGTH
Latching D-Ring	HY-LDR-506(L)	400 lb	1200 lbs
	HY-LDR-550(M)	226 lb	800 lb
	HY-LDR-549(S)	100 lb	300 lb

# TRACK BUNGEE



ITEM	ITEM NO.	SIZE	DETAILS
Track Bungee	HY-TB-711	6in	E TRACK CONNECTORS SEWN AT EACH END FINISH: YELLOW ZINC METAL SLEEVE ON BOTH ENDS TO PROTECT THE BUNGEE
	HY-TB-712	9in	
	HY-TB-713	12in	

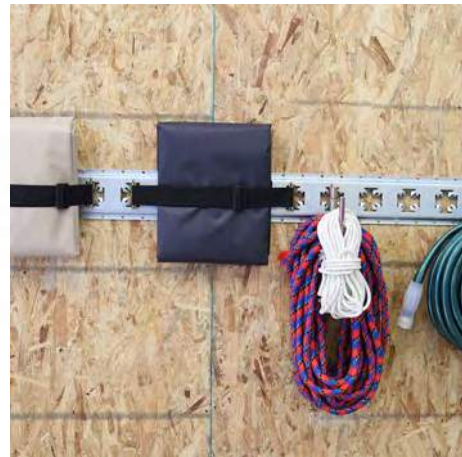
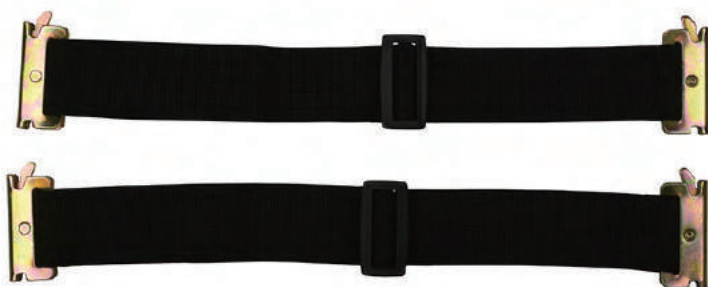

ITEM	ITEM NO.	SIZE	DETAILS
Track Bungee	HY-TB-714	16-24in	E TRACK CONNECTORS SEWN AT EACH END FINISH: YELLOW ZINC METAL SLEEVE ON BOTH ENDS TO PROTECT THE BUNGEE
	HY-TB-715	22-32in	
	HY-TB-716	28-48in	

# ACCESSORIES CATALOG

NINGBO YINZHOU HENGYU AUTO PARTS MANUFACTURER CATALOG 2023



# RATCHET TIE DOWN



**HYRTD-001**  
 A=103mm  
 B=325mm  
 C=140mm  
 D=75mm  
 PULL≤10000KG



**HYRTD-002**  
 A=78mm  
 B=325mm  
 C=140mm  
 D=75mm  
 PULL≤10000KG



**HYRTD-003**  
 A=53mm  
 B=330mm  
 C=105mm  
 D=60mm  
 PULL≤5000KG



**HYRTD-004**  
 A=53mm  
 B=300mm  
 C=105mm  
 D=60mm  
 PULL≤5000KG



**HYRTD-005**  
 A=52mm  
 B=230mm  
 C=105mm  
 D=58mm  
 PULL≤5000KG



**HYRTD-006**  
 A=52mm  
 B=230mm  
 C=105mm  
 D=58mm  
 PULL≤5000KG



**HYRTD-007**  
 A=52mm  
 B=230mm  
 C=105mm  
 D=58mm  
 PULL≤5000KG



**HYRTD-008**  
 A=52mm  
 B=230mm  
 C=110mm  
 D=58mm  
 PULL≤5000KG

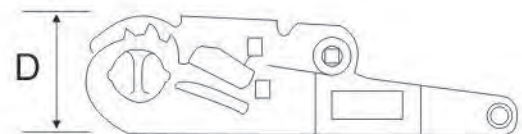
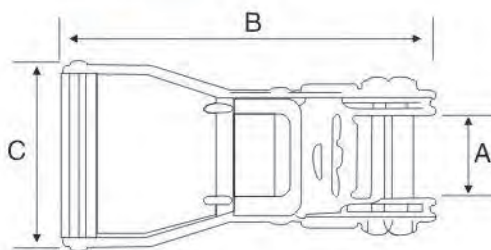

# RATCHET TIE DOWN



**HYRTD-009**

A=52mm  
B=196mm  
C=105mm  
D=58mm  
PULL≤5000KG



**HYRTD-010**

A=52mm  
B=230mm  
C=110mm  
D=58mm  
PULL≤5000KG



**HYRTD-011**

A=52mm  
B=165mm  
C=78mm  
D=58mm  
PULL≤5000KG



**HYRTD-012**

A=52mm  
B=160mm  
C=78mm  
D=52mm  
PULL≤2000KG



**HYRTD-013**

A=54mm  
B=145mm  
C=93mm  
D=40mm  
PULL≤2000KG



**HYRTD-014**

A=39mm  
B=155mm  
C=85mm  
D=50mm  
PULL≤3000KG



**HYRTD-015**

A=39mm  
B=160mm  
C=85mm  
D=50mm  
PULL≤3000KG



**HYRTD-016**

A=39mm  
B=160mm  
C=85mm  
D=50mm  
PULL≤3000KG

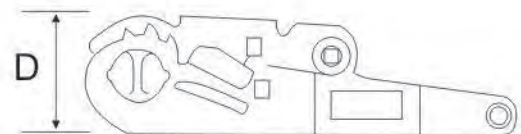
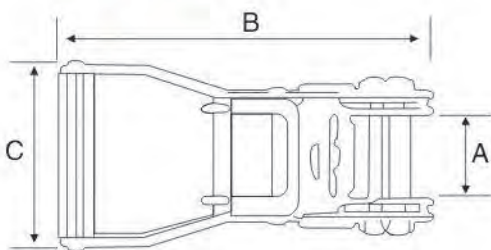

# RATCHET TIE DOWN



**HYRTD-017**

A=39mm  
B=130mm  
C=75mm  
D=40mm  
PULL ≤ 2000KG



**HYRTD-018**

A=39mm  
B=155mm  
C=60mm  
D=50mm  
PULL ≤ 3000KG



**HYRTD-019**

A=34mm  
B=150mm  
C=70mm  
D=45mm  
PULL ≤ 1500KG



**HYRTD-020**

A=34mm  
B=145mm  
C=80mm  
D=45mm  
PULL ≤ 1500KG



**HYRTD-021**

A=34mm  
B=170mm  
C=65mm  
D=45mm  
PULL ≤ 1500KG



**HYRTD-022**

A=28mm  
B=125mm  
C=70mm  
D=42mm  
PULL ≤ 1500KG



**HYRTD-023**

A=28mm  
B=130mm  
C=65mm  
D=42mm  
PULL ≤ 1500KG



**HYRTD-024**

A=28mm  
B=120mm  
C=62mm  
D=42mm  
PULL ≤ 1500KG

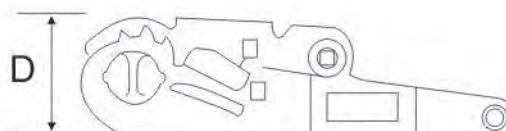
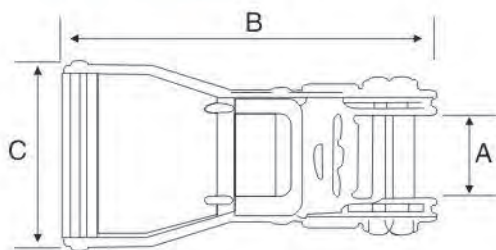



# RATCHET TIE DOWN



**HYRTD-025**  
 A=28mm  
 B=130mm  
 C=46mm  
 D=42mm  
 PULL≤1500KG



**HYRTD-026**  
 A=28mm  
 B=110mm  
 C=46mm  
 D=42mm  
 PULL≤1500KG



**HYRTD-027**  
 A=26mm  
 B=135mm  
 C=60mm  
 D=42mm  
 PULL≤1200KG



**HYRTD-028**  
 A=26mm  
 B=112mm  
 C=37mm  
 D=42mm  
 PULL≤680KG



**HYRTD-029**  
 A=26mm  
 B=112mm  
 C=37mm  
 D=42mm  
 PULL≤680KG



**HYRTD-030**  
 A=26mm  
 B=112mm  
 C=37mm  
 D=42mm  
 PULL≤680KG



**HYRTD-031**  
 A=26mm  
 B=115mm  
 C=37mm  
 D=42mm  
 PULL≤680KG



**HYRTD-032**  
 A=26mm  
 B=120mm  
 C=37mm  
 D=42mm  
 PULL≤680KG

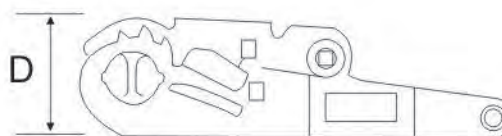
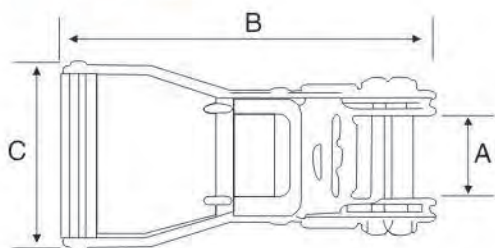

# BUCKLES



**HY-OBU-041**

A=52mm  
B=132mm  
C=60mm



**HYOBU-043SS**

A=52mm  
B=180mm  
C=65mm  
D=25mm  
PULL≤600KG



**HYOBU-044SS**

A=52mm  
B=170mm  
C=65mm  
D=25mm  
PULL≤800KG



**HYOBU-045SS**

A=48mm  
B=150mm  
C=60mm  
D=25mm  
PULL≤800KG



**HYPB-046SS**

A=52mm  
B=110mm  
C=68mm  
D=22mm  
PULL≤450KG



**HYPB-047SS**

A=26mm  
B=90mm  
C=42mm  
D=18mm  
PULL≤450KG



**HYAP-003**

The head : Chrome-plated zinc alloy  
The Screw: 3 / 8 "  
The length: 85mm



**HYAP-004**

The head : Chrome-plated zinc alloy  
The Screw: 3 / 8 "  
The length: 85mm

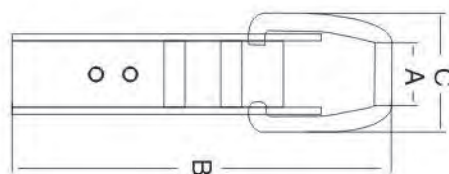
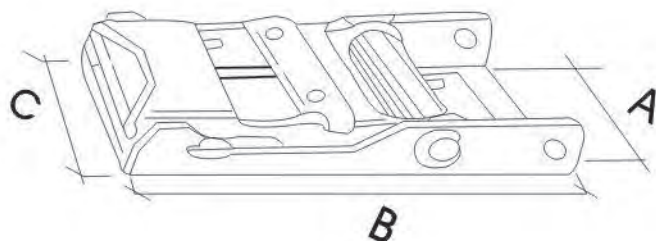

# BUCKLES



**HYBU-048**

A=54mm  
B=75mm  
C=62mm  
D=30mm  
PULL ≤ 1000KG



**HYBU-049**

A=42mm  
B=62mm  
C=48mm  
D=28mm  
PULL ≤ 800KG

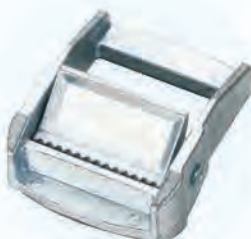

**HYBU-050**

A=36mm  
B=60mm  
C=48mm  
D=26mm  
PULL ≤ 800KG



**HYBU-051**

A=28mm  
B=64mm  
C=36mm  
D=26mm  
PULL ≤ 680KG



**HYBU-052**

A=28mm  
B=64mm  
C=44mm  
D=26mm  
PULL ≤ 680KG



**HYPF-053**

A=38mm  
B=145mm  
C=100mm  
D=60mm  
PULL ≤ 1600KG



**HYPF-054**

A=30mm  
B=104mm  
C=70mm  
D=45mm  
PULL ≤ 800KG



**HYSH-055A**

A=24mm  
B=80mm  
C=8mm  
PULL ≤ 680KG

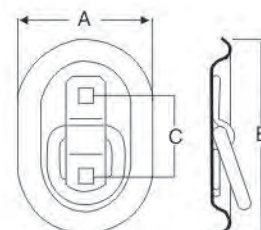
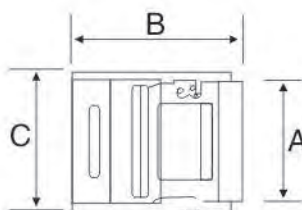



# HOOK



**HYSH-055B**

A=24mm  
B=96mm  
C=10.5mm  
PULL≤1500KG



**HYSH-056**

A=24mm  
B=102mm  
C=9.8mm  
PULL≤2500KG



**HYSH-057**

A=24mm  
B=125mm  
C=10mm  
PULL≤1500KG



**HYSH-058**

A=24mm  
B=108mm  
C=8mm  
PULL≤800KG



**HYSH-059**

A=24mm  
B=125mm  
C=8mm  
PULL≤800KG



**HYSH-060**

A=27mm  
B=110mm  
C=10mm  
PULL≤1500KG



**HYSH-061**

A=26mm  
B=102mm  
C=9.8mm  
PULL≤2500KG



**HYDH-062**

A=28mm  
B=65mm  
C=8mm  
PULL≤1500KG

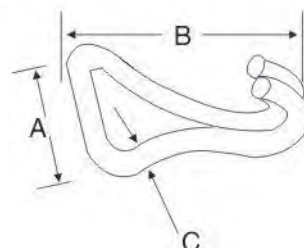
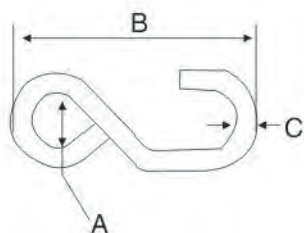

# HOOK



**HYDH-063**  
 A=26mm  
 B=52mm  
 C=7.2mm  
 PULL ≤ 1200KG



**HYDH-064**  
 A=52mm  
 B=120mm  
 C=12.2mm  
 PULL ≤ 5000KG



**HYDH-065**  
 A=52mm  
 B=85mm  
 C=11.5mm  
 PULL ≤ 5000KG



**HYDH-066**  
 A=52mm  
 B=98mm  
 C=9.8mm  
 PULL ≤ 5000KG



**HYDH-067**  
 A=52mm  
 B=80mm  
 C=9.8mm  
 PULL ≤ 3000KG



**HYDH-068**  
 A=39mm  
 B=65mm  
 C=8mm  
 PULL ≤ 2000KG



**HYDH-069**  
 A=26mm  
 B=50mm  
 C=7.2mm  
 PULL ≤ 1200KG



**HY-FH-081**  
 A=15mm  
 B=67mm  
 C=4mm

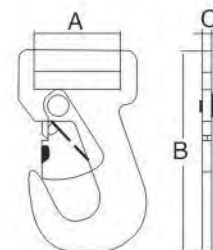
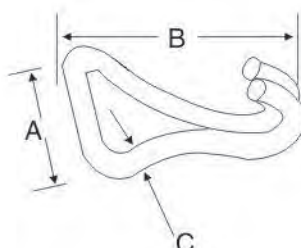
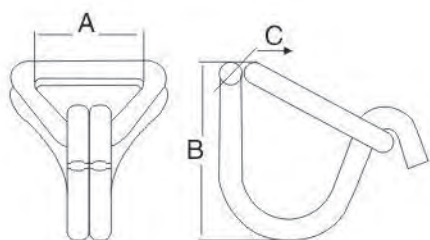

# HOOK



**HYFH-071**  
 A=26mm  
 B=96mm  
 C=4mm  
 PULL≤1500KG



**HYFH-072**  
 A=45.5mm  
 B=108mm  
 C=4.5mm  
 PULL≤2500KG



**HYFH-073**  
 A=50mm  
 B=160mm  
 C=6mm  
 PULL≤4540KG



**HYFH-074**  
 A=50mm  
 B=160mm  
 C=6mm  
 PULL≤4540KG



**HYFH-075**  
 A=50mm  
 B=96mm  
 C=4.5mm  
 PULL≤2000KG



**HYFH-076**  
 A=50mm  
 B=75mm  
 C=4.5mm  
 PULL≤3000KG

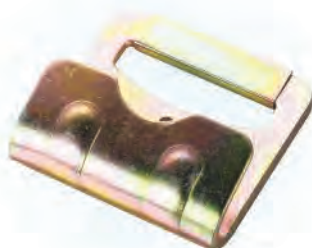

**HYFH-077**  
 A=70mm  
 B=98mm  
 C=5mm  
 PULL≤6800KG

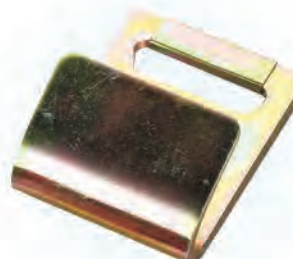

**HYFH-078**  
 A=48mm  
 B=92mm  
 C=4.5mm  
 PULL≤5000KG

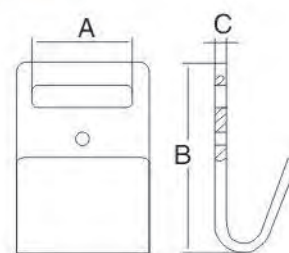
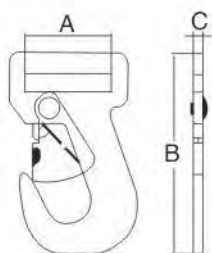



# HOOK



**HY-FH-080**  
 L=75.6mm  
 W=90mm  
 H=5.5mm



**HY-FH-082**  
 L=75mm  
 W=97mm  
 H=91mm



**HY-FH-081**  
 L=65mm  
 W=62mm  
 H=31mm



**HY-SJH-001**  
 L=83.6mm  
 W=115.5mm  
 H=32mm



**HY-FH-082**  
 L=83mm  
 W=98mm  
 H=40mm



**HY-SJH-002**  
 L=87mm  
 W=100mm  
 H=30mm



**HY-WIN-001**  
 L=123mm  
 W=102mm  
 H=95mm



**HY-SJH-003**  
 L=66mm  
 W=97mm  
 H=29mm

# D RING



**HYFH-079**  
 A=29mm  
 B=53mm  
 C=3mm  
 PULL≤1500KG



**HYFH-080**  
 A=26mm  
 B=30mm  
 C=2.5mm  
 PULL≤800KG



**HYDR-081**  
 A=52mm  
 B=79mm  
 C=5mm  
 PULL≤5000KG



**HYDR-082**  
 A=52mm  
 B=73mm  
 C=11.5mm  
 PULL≤5000KG



**HYDR-083**  
 A=50mm  
 B=68mm  
 C=5mm  
 PULL≤5000KG



**HYDR-084**  
 A=50mm  
 B=60mm  
 C=7mm  
 PULL≤2000KG



**HYDR-085**  
 A=38mm  
 B=60mm  
 C=10mm  
 PULL≤3000KG



**HYPB-086**  
 A=32mm  
 B=180mm  
 C=58mm  
 PULL≤2000KG

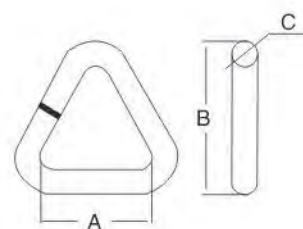
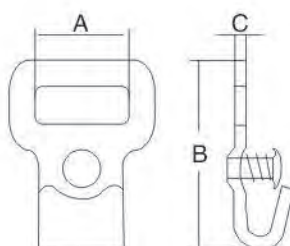
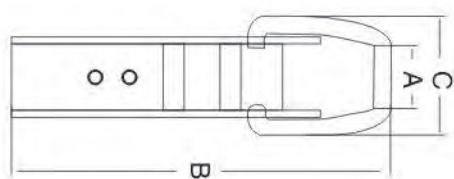

# HOOK/DOUBLE STUD FITTING



**HY-DSF-095**

B=62mm



**HYUH-088**

A=52mm  
B=92mm  
C=17mm  
PULL ≤ 10000KG



**HYUH-089**

A=52mm  
B=60mm  
C=11.5mm  
PULL ≤ 5000KG



**HYUH-090**

A=39mm  
B=55mm  
C=10mm  
PULL ≤ 3000KG



**HYSH-091**

A=52mm  
B=38mm  
C=10mm  
PULL ≤ 3000KG



**HYSH-092**

A=52mm  
B=36mm  
C=8mm  
PULL ≤ 1500KG



**HYDSF-093**

A=44mm  
B=100mm  
C=7mm  
PULL ≤ 2300KG



**HYDSF-094**

A=38mm  
B=105mm  
C=8mm  
PULL ≤ 2300KG

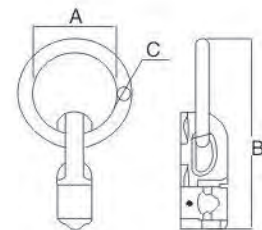
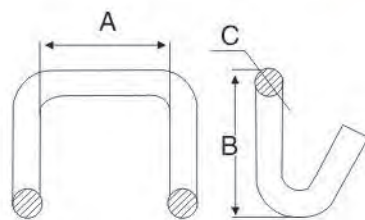
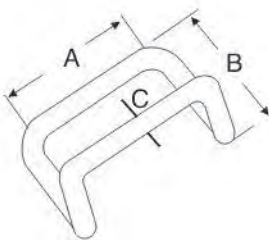



# FASTENER



**HYSSF-095**  
 A=45mm  
 B=78mm  
 C=5mm  
 PULL≤1800KG



**HYSSF-096**  
 A=35mm  
 B=66mm  
 C=5mm  
 PULL≤1800KG



**HYSSF-097**  
 A=29mm  
 B=62mm  
 C=5mm  
 PULL≤1800KG



**HYSSF-098**  
 A=10mm  
 B=49.5mm  
 C=1.5mm  
 PULL≤710KG



**HYSSF-099**  
 A=38mm  
 B=90mm  
 C=8mm  
 PULL≤3000KG



**HYFH-100**  
 A=52mm  
 B=77mm  
 C=30mm  
 PULL≤1600KG



**HYFN-001**  
 A=12mm  
 B=101.5mm  
 C=20mm



**HYFN-002**  
 A=M12mm  
 B=76mm  
 C=20mm

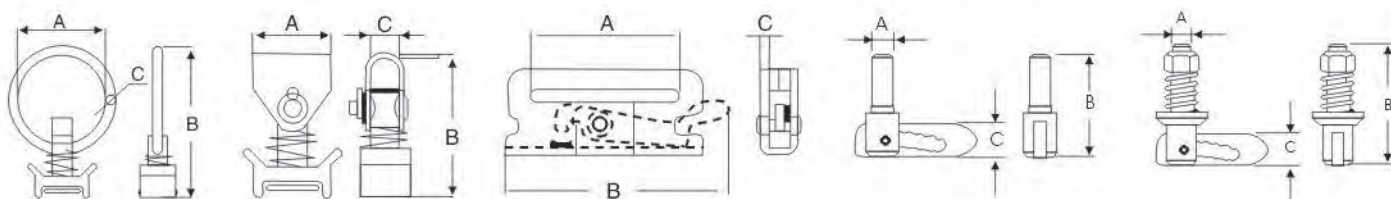

## Note

---

---

---

---

---

---

---

---

---

---

---

---

---

---

---

---

---

---

---

---

---

---

---

---

---

---



[www.cnhengyu.com](http://www.cnhengyu.com)



[sales@cnhengyu.com](mailto:sales@cnhengyu.com)

E-Catalog Online







# NINGBO HENGYU AUTO PARTS MANUFACTURER

## Ningbo Office

 No.748-6 Wuxiang East Road,  
Wuxiang Town, Yinzhou,  
Ningbo, China

## Thai Office

 371/4 Moo 6, Tambol Bowin,  
Amphur Sriracha, Chonburi  
20230 Head Office



[www.cnhengyu.com](http://www.cnhengyu.com)



[sales@cnhengyu.com](mailto:sales@cnhengyu.com)

E-Catalog Online

